

Signal	Color (CF10.05.05)	8-10-0104 Male
U	Brown	1
V	White	4
W	Grey	3
GND	Shield	Case
T+	Yellow	5
T-	Green	6

Signal	Color (CF10.07.05)	8-10-0104 Male
U	Black-2	1
V	Black-1	4
W	Black-3	3
GND	Shield	Case
T-	Black-4	5
T-	Yellow/Green	6

Function	Signal	Color	8-10-0089 Male
Power	5V	Brown	4
		White	5
		Green	12
Clock	MA+	Violet	7
	MA-	Yellow	6
	SLO+	Grey	11
Data	SLO-	Pink	3
	Outer Shield	Shield	Case

Signal	Color	D-Sub Male-9P
2-A	Black	1
-	Blue	2
-	-	3
-	-	4
-	-	5
+	Brown	6
1-A	Black	7
-	-	8
-	-	9

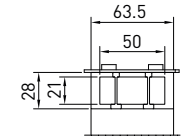
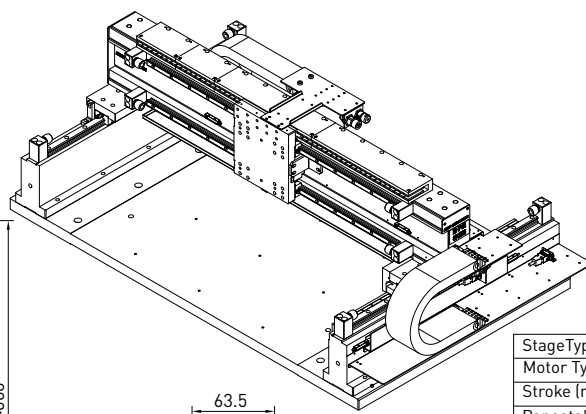
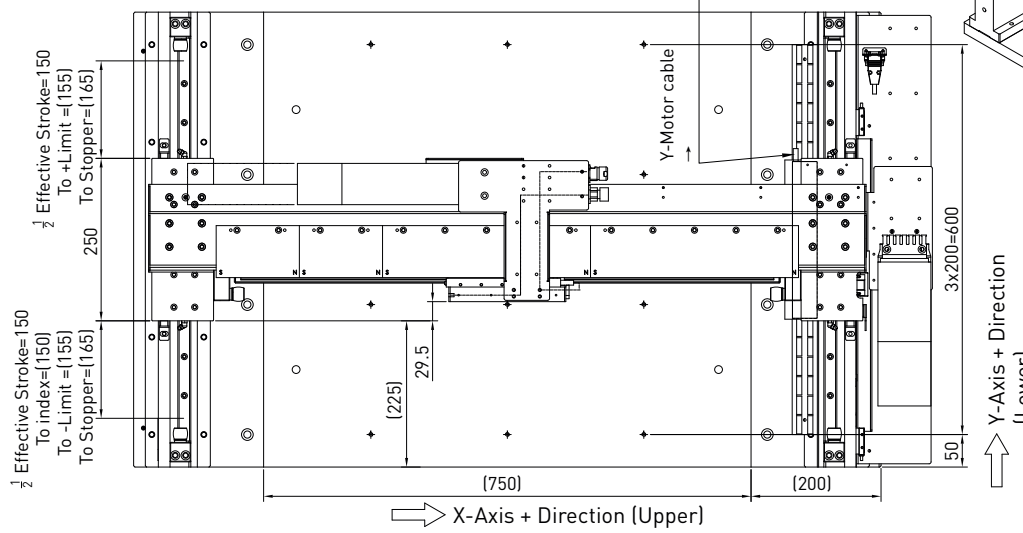

View A (Cable inlet)
X-axis Cable Chain type :
1400.050.048.0
21.1*2 per 2 elements

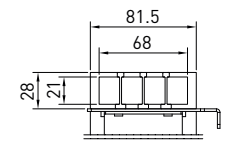

View B (Cable inlet)
Y-axis Cable Chain type :
1400.068.075.0
21.1*3 per 2 elements

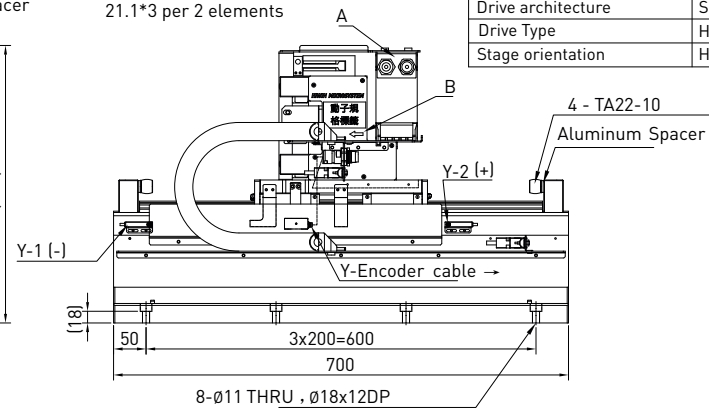
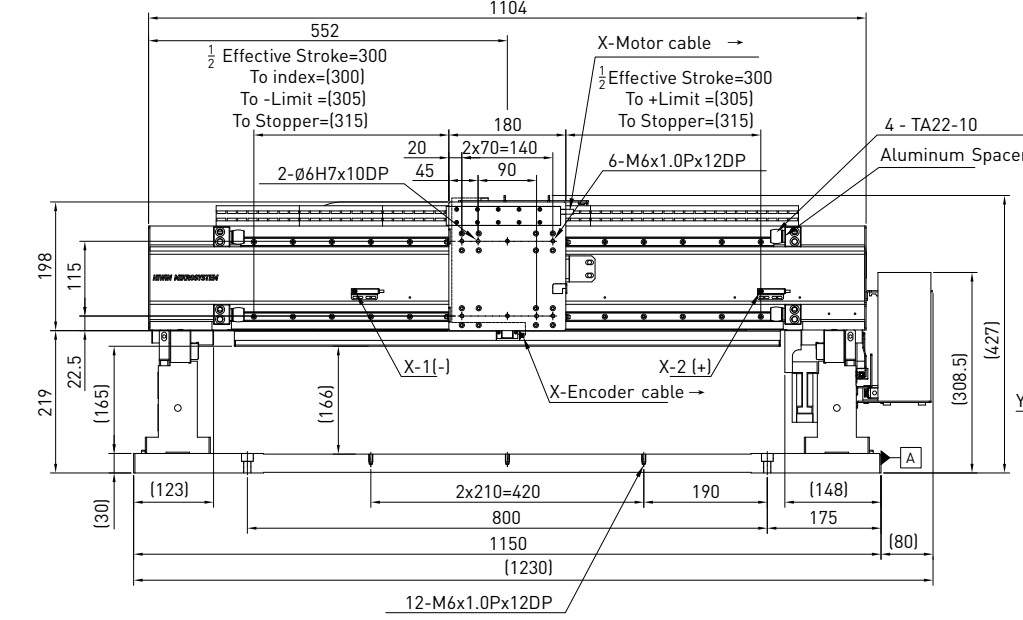

StageType	LMG2A-CB5-CEFE4-600-300-X10C
Motor Type	X-axis(upper) : LMCB5 ; Y-axis(lower) : LMCEFE4
Stroke (mm)	X-axis(upper) : 600 ; Y-axis(lower) : 300
Repeatability (µm)	X-axis : ± 2 ; Y-axis : ± 2 (with HIWIN solution)
Accuracy (µm)	X-axis : ± 3 ; Y-axis : ± 3 (with error-mapping)
Max. Velocity (m/s)	X-axis : 0.5 ; Y-axis : 0.5 (with payload)
Max. Acceleration(m/s^2)	X-axis : 5 ; Y-axis : 5 (with payload)
Linear Encoder	Absolute, BiSS 26 bit , 50nm, EL26BBB050FxxA
Linear Scale	RTLA50-S
Vertical Straightness (µm)	± 10 / 300 mm
Horizontal Straightness (µm)	± 10 / 300 mm
Yaw (arc-sec)	± 10 / 300 mm
Pitch (arc-sec)	± 10 / 300 mm
Orthogonality (arc-sec)	10 (200x200mm central stroke)
Limit Switches	Wenglor Inductive PNP (NC) , 11BH009
Moving Slide	Aluminum with black anodized finish
Stationary Base	Aluminum with black anodized finish
Payload (kg)	10
Moving Mass (kg)	X-axis : { 5 } ; Y-axis : { 50 }
Stage Weight (kg)	{ 170 }
Grease Type	HIWIN G04 (for normal environment)
Input voltage(V)	220
Drive architecture	Single
Drive Type	HIWIN ED1 recommended
Stage orientation	Horizontal

HIWIN MIKROSISTEM CORP.		TYPE	LM ROBOTS (Gantry)
ROUGH	FIT	CUSTOMER	H-GERMANY
8.0µ	▽	DATE	Apr.24.23
3.2µ	▽	MATERIAL	
0.8µ	▽	FINISH	
TOLERANCE mm		PART NO	FM22M2343000
UP	6	NAME	
TD	4	DWG NO	
	30	APPD	張家樂
	120		
	300		
	600		
	1200		
	2400		
	2400		
	±0.2	APPROVAL	M23430 A2 1-1
	±0.3		
	±0.4		
	±0.5		
	±0.8		
	±1.0		
	±1.5		