

Y-Axis + Direction
(Lower)

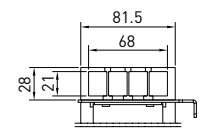

View B (Cableinlet)
Y-axis Cable Chain type:
1400.068.075.0
21.1*3 per 2 elements

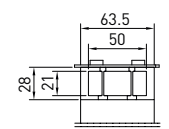

View A (Cableinlet)
X-axis Cable Chain type:
1400.050.048.0
21.1*2 per 2 elements

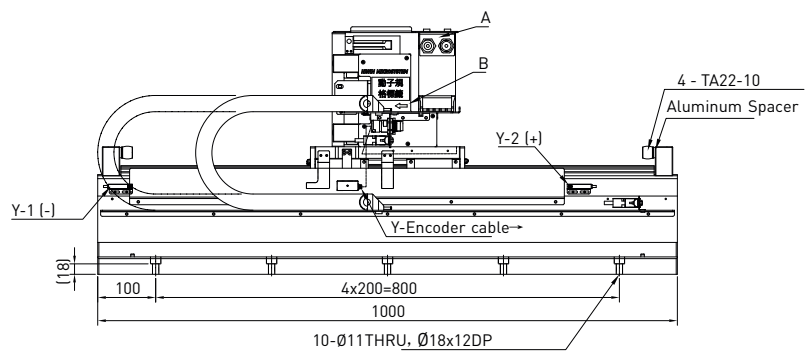

X-Axis Motor wiring diagram		
Signal	Color (CF1905.05)	8-10-0104 Male
U	Brown	1
V	White	4
W	Grey	3
GND	Shield	Case
T+	Yellow	5
T-	Green	6

Y-Axis Motor wiring diagram		
Signal	Color (CF1907.05)	8-10-0104 Male
U	Black-2	1
V	Black-1	4
W	Black-3	3
GND	Shield	Case
T+	Black-4	5
T-	Yellow/Green	6

Positioning Measurement-Absolute(BISS-C)			
Function	Signal	Color	8-10-0089 Male
Power	5V	Brown	4
	0V	White	5
	0V	Green	12
Clock	MA+	Violet	7
	MA-	Yellow	6
Data	SLO+	Grey	11
	SLO-	Pink	3
Outer Shield	Shield	-	Case

Limit switch wiring diagram			
Signal	Color	D-Sub Male-9P	
2-A	Black	1	
	Blue	2	
	Blue	3	
	Blue	4	
	Brown	5	
1-A	Black	7	
	Black	8	
	Black	9	

StageType	LMG2A-CB5-CEFE4-600-600-X10C
Motor Type	X-axis(upper) : LMCB5 ; Y-axis(lower) : LMCEFE4
Stroke (mm)	X-axis(upper) : 600 ; Y-axis(lower) : 600
Repeatability (µm)	X-axis : ± 2 ; Y-axis : ± 2 (with HIWIN solution)
Accuracy (µm)	X-axis : ± 3 ; Y-axis : ± 3 (with error-mapping)
Max. Velocity (m/s)	X-axis : 0.5 ; Y-axis : 0.5 (with payload)
Max. Acceleration(m/s^2)	X-axis : 5 ; Y-axis : 5 (with payload)
Linear Encoder	Absolute, BiSS 26 bit , 50nm, EL26BBB050FxxA
Linear Scale	RTL450-S
Vertical Straightness (µm)	± 10 / 300 mm
Horizontal Straightness (µm)	± 10 / 300 mm
Yaw (arc-sec)	± 10 / 300 mm
Pitch (arc-sec)	± 10 / 300 mm
Orthogonality (arc-sec)	10 (200x200mm central stroke)
Limit Switches	Wenglor Inductive PNP (NC) , 11BH009
Moving Slide	Aluminum with black anodized finish
Stationary Base	Aluminum with black anodized finish
Payload (kg)	10
Moving Mass (kg)	X-axis : { 5 } ; Y-axis : { 50 }
Stage Weight (kg)	{ 210 }
Grease Type	HIWIN G04 (for normal environment)
Input voltage(V)	220
Drive architecture	Single
Drive Type	HIWIN ED1 recommended
Stage orientation	Horizontal

HIWIN MIKROSISTEM CORP.		TYPE	LM ROBOTS (Gantry)
CUSTOMER		H-GERMANY	DATE Apr.21.23
MATERIAL			DWN 顏靜涵
FINISH			CHK 黃鈺婷
PART NO		FM22M2342900	APPD 張家樂
NAME		DWG NO	SHEET
APPROVAL		M23429	A2 1-1